

# MTL700 RANGE ACCESSORIES

- Mounting kits for up to 20 barriers
- Busbar, earth terminals and insulating mounting blocks for separate connection to IS earth
- Earth terminal rail for cable screens and earth returns
- Integral tagging system to display barrier loop data

## DO-IT-YOURSELF MOUNTING ARRANGEMENT

Barriers are carried on lightweight plated busbar, which can be mounted on 'top hat' or G-profile rail or any flat surface with the busbar insulated for separate earthing. It is recommended that twin earth cables should be used for maximum security and easy testing. Each barrier is clamped to the busbar and thereby earthed in a single operation, making it virtually impossible to forget the earth connection, so easily left untightened or untested if there are scores of individual earth wires. Robust soft-plated double fixing studs on the top of each barrier ensure permanent 'gas-tight' joints, which are immune to vibration and corrosion yet allow barriers to be installed, inspected and removed easily.

The accessories system also provides a convenient row of terminals for terminating earth returns and cable screens, which remains in place to keep these safely earthed should any barrier be extracted: a dummy barrier is available as an alternative for the same purpose. With similar attention to users' needs, a unique lift-up tagging facility provides permanent identification of circuits and barrier types to guide installation, fault-finding and inspection, and to ensure correct replacement of any barrier for long-term safety.

## ACCESSORIES

**EBB7 earth busbar**, nickel-plated brass and ready drilled in one metre lengths.

**IMB7 & SMB7 insulating mounting blocks** are a convenient method of supporting the busbar. They are supplied complete with fixing screws and are ready for mounting on any flat surface. IMB7 will also mount on top hat or G-profile DIN-rail. T-section DIN-rail **THR2** is available in 1 metre lengths.

**TAG7 tagging strips** clip onto the mounting blocks to positively identify each location and provide space for the user to note details of barrier type, loop identification etc. Access to barrier mounting studs is not impaired; just unclip one edge and swing the strip 'open' or, if the optional plastic seal (**TGS7**) has not been fitted, unclip both edges and lift it right off. **TGL7** replacement labels for the tagging strips are also available.

**ERL7 earth rail** is a nickel-plated 3 x 10mm rail that attaches to the mounting blocks via an **ERB7** earth rail mounting bracket. It will accommodate up to 2.5 **ETM7** earth terminals per barrier location for terminating earth returns and cable screens from the hazardous area.

**ERB7 earth rail mounting bracket** mounts directly over either type of mounting block; for a rigid earth rail an **ERB7** on each mounting block is recommended. One end carries a bolt-down fitting for the rail – enabling easy removal for adding extra **ETM7** terminals – the other end carries a 16mm<sup>2</sup> terminal. When installed these 16mm<sup>2</sup> terminals provide connections for the high-integrity IS earth, for linking between sections of busbar, and for a common earth return from the safe area.

**Other accessories available** are the **TQS7** torque spanner for safe tightening of the vibration-proof self-locking nuts on the barrier earthing studs; **SMC7** surface mounting clips for mounting a single barrier on a flat surface; and **ISL3** or **ISL7** self adhesive 'Take Care' intrinsic safety warning labels.

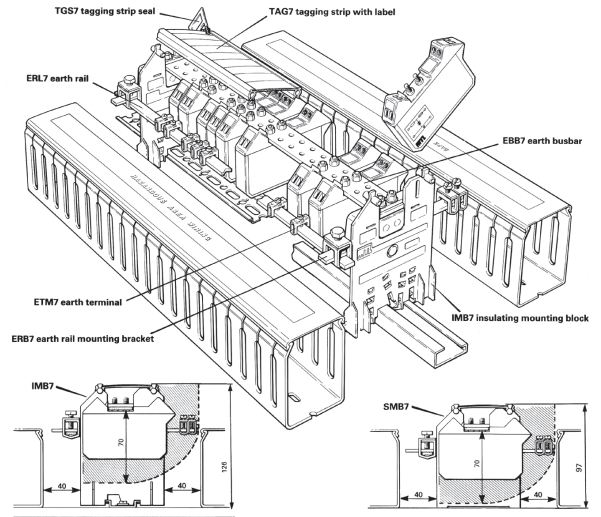

**End elevations with recommended spacing.** Shaded portions show areas swept by barrier during installation and removal.

## MOUNTING KITS

Mounting kits provide all the necessary parts for installing up to a specific number of MTL700 or MTL700P range of barriers. The kits available are the MK02 (2 barriers), MK05 (5 barriers), MK12 (12 barriers), and MK20 (20 barriers). Each kit provides facilities for mounting and earthing the barriers, connecting the IS earth cable, terminating cable screens and noting tagging information (except the MK02 kit which does not provide tagging facilities). Instruction Sheet INS701 includes full assembly instructions.

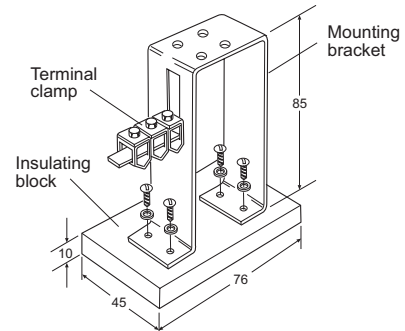

**MK02 Assembly diagram**

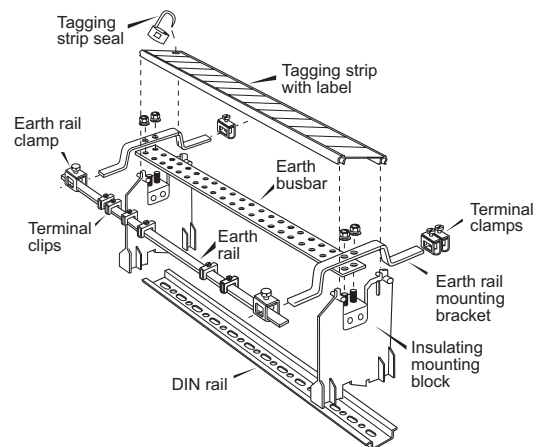

**MK05, MK12, MK20 Assembly diagram**

*Note: MK05 has no earth rail, but does have terminal clamps on earth rail mounting brackets*

**EATON**  
Powering Business Worldwide

**Eaton Electric Limited,**  
Great Marlings, Butterfield, Luton  
Beds, LU2 8DL, UK.  
Tel: + 44 (0)1582 723633 Fax: + 44 (0)1582 422283  
E-mail: [mtlenquiry@eaton.com](mailto:mtlenquiry@eaton.com)  
[www.mtl-inst.com](http://www.mtl-inst.com)

© 2016 Eaton  
All Rights Reserved  
Publication No. EPS700 Rev 5 031116  
November 2016

**EUROPE (EMEA):**  
+44 (0)1582 723633  
[mtlenquiry@eaton.com](mailto:mtlenquiry@eaton.com)

**THE AMERICAS:**  
+1 800 835 7075  
[mtl-us-info@eaton.com](mailto:mtl-us-info@eaton.com)

**ASIA-PACIFIC:**  
+65 6 645 9888  
[sales.mtlsing@eaton.com](mailto:sales.mtlsing@eaton.com)

The given data is only intended as a product description and should not be regarded as a legal warranty of properties or guarantee. In the interest of further technical developments, we reserve the right to make design changes.

## DIMENSIONS (mm)

**TAG7 tagging strip** with label and 6 'clit' rivets – 1 metre lengths

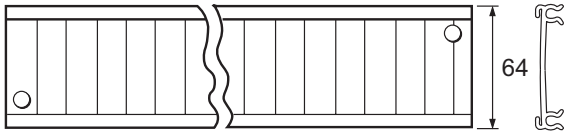

**TGL7 tagging strip label only** – packs of 10 x 0.5 metre lengths

**ERL7 earth rail** – 10 x 3mm - sold in 1 metre lengths. Unplated rail available as 'SSch 10 x 3mm brass busbar', from Klippon Electricals Ltd.

**ERB7 earth rail mounting bracket** – with earth rail bolt-down fitting and terminal for cable 16mm<sup>2</sup>

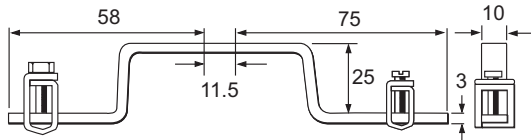

**EBB7 earth busbar** – 1 metre lengths. Mounts up to 64 barriers.

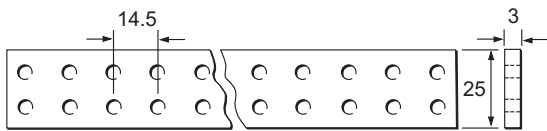

**IMB7 insulating mounting block** mounts on a flat surface or top hat rail (to EN 50 022 – 35 x 7.5; BS 5584; 35 x 27 x 7.3 DIN 46277) or G-profile rail (to EN 50035 – G32; BS 5825; 32 DIN 46277). Recommended maximum number of barriers between blocks is 25.

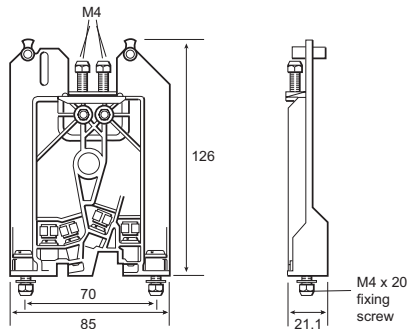

**SMB7 insulating mounting block** mounts on a flat surface and provides minimum overall installation height. Recommended maximum number of barriers between blocks is 25.

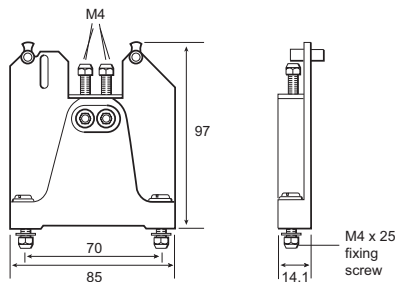

**TGS7 tagging strip seal**

– sold in bags of 10



**ETM7 earth terminal** – sold in bags of 50. For cable 4mm<sup>2</sup>. Also available as 'ZB4' from Klippon Electricals Ltd.



**SMC7 surface mounting clip** – sold in bags of 10. Two clips needed per barrier.

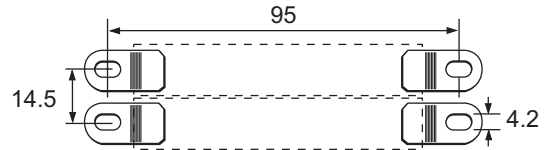

**TQS7 torque spanner** – preset to 2.3Nm torque. Complete with 7mm A/F socket.



**ISL3 or ISL7 'Take Care' intrinsic safety label** –

ISL3 adhesive back, metal

\*ISL7 adhesive front, plastic

**DRK700 adaptor kit**

allows MTL700 range of barriers to be mounted directly on DIN-rails



**ENCLOSURE OPTIONS**

Dimensions (mm)

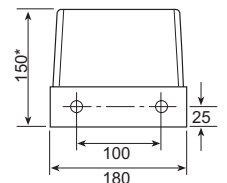
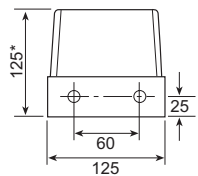
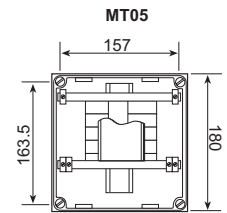
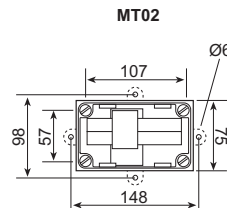

\*Add 5mm to depth if fixing lugs are used.

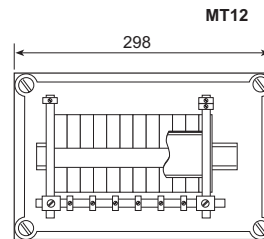

**Fixing lugs for MT12**

On these models the screw-on fixing lugs can be positioned as shown.

**EATON**

Powering Business Worldwide

**Eaton Electric Limited,**  
Great Marlings, Butterfield, Luton  
Beds, LU2 8DL, UK.  
Tel: + 44 (0)1582 723633 Fax: + 44 (0)1582 422283  
E-mail: [mtlenquiry@eaton.com](mailto:mtlenquiry@eaton.com)  
[www.mtl-inst.com](http://www.mtl-inst.com)

© 2016 Eaton  
All Rights Reserved  
Publication No. EPS700 Rev 5 031116  
November 2016

**EUROPE (EMEA):**  
+44 (0)1582 723633  
[mtlenquiry@eaton.com](mailto:mtlenquiry@eaton.com)

**THE AMERICAS:**  
+1 800 835 7075  
[mtl-us-info@eaton.com](mailto:mtl-us-info@eaton.com)

**ASIA-PACIFIC:**  
+65 6 645 9888  
[sales.mtlsing@eaton.com](mailto:sales.mtlsing@eaton.com)

The given data is only intended as a product description and should not be regarded as a legal warranty of properties or guarantee. In the interest of further technical developments, we reserve the right to make design changes.