

THIRD ANGLE PROJECTION

DO NOT SCALE

DIMENSIONS IN mm

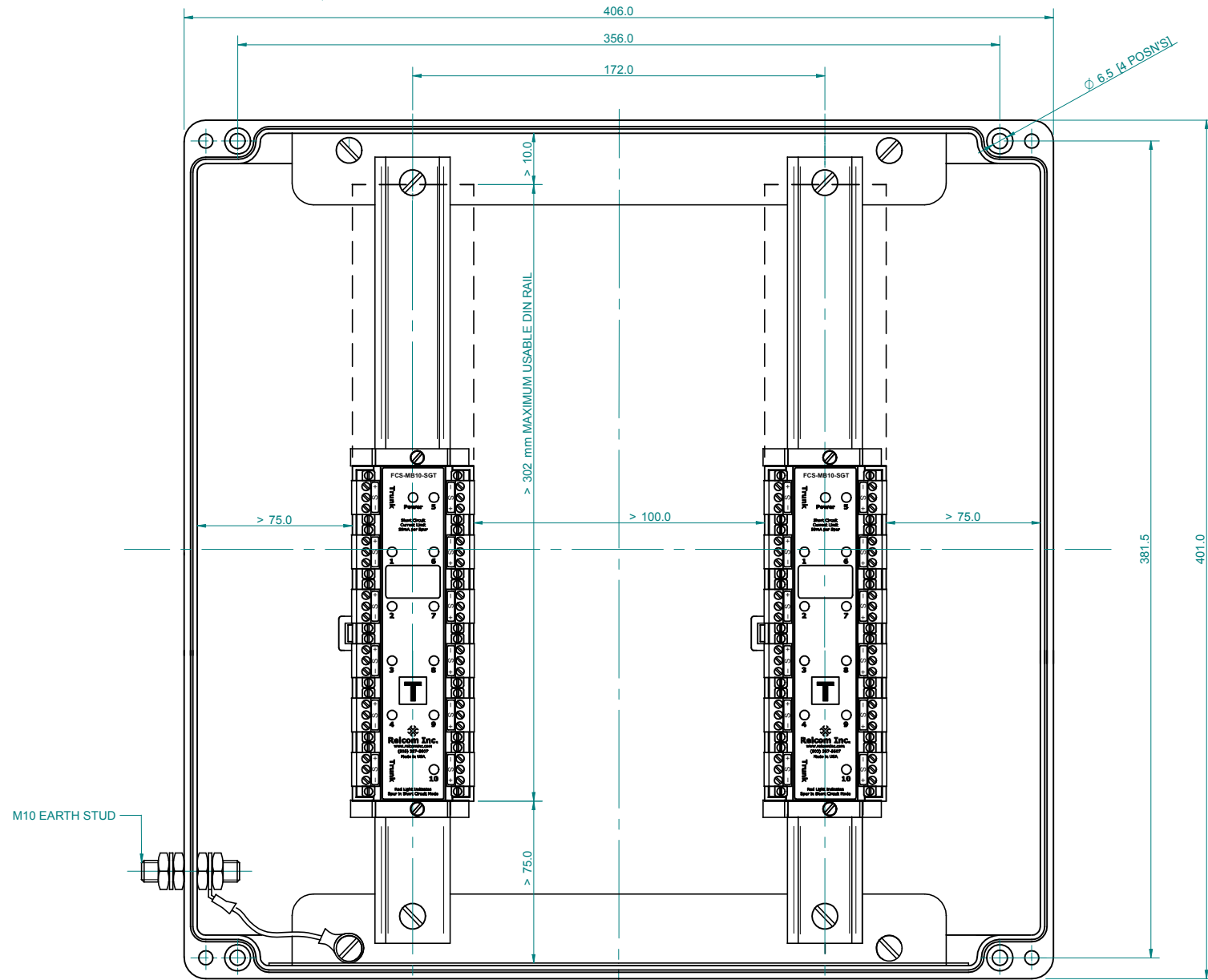

VIEW WITH LID REMOVED

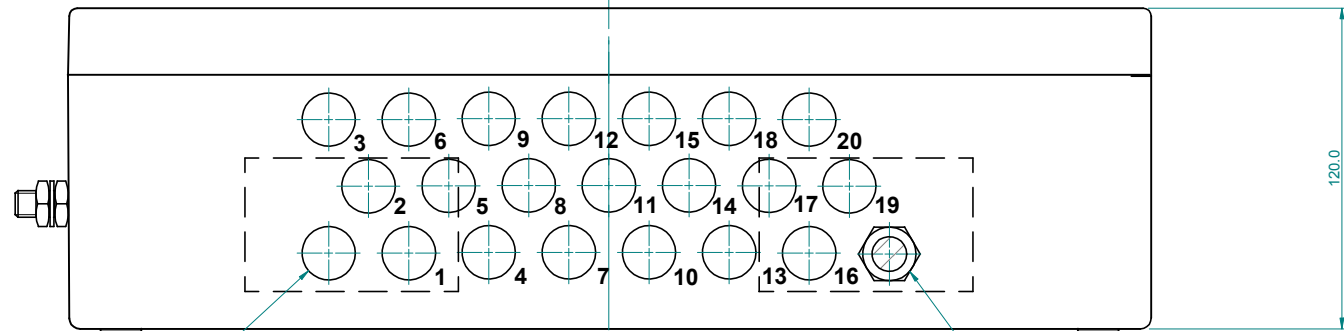
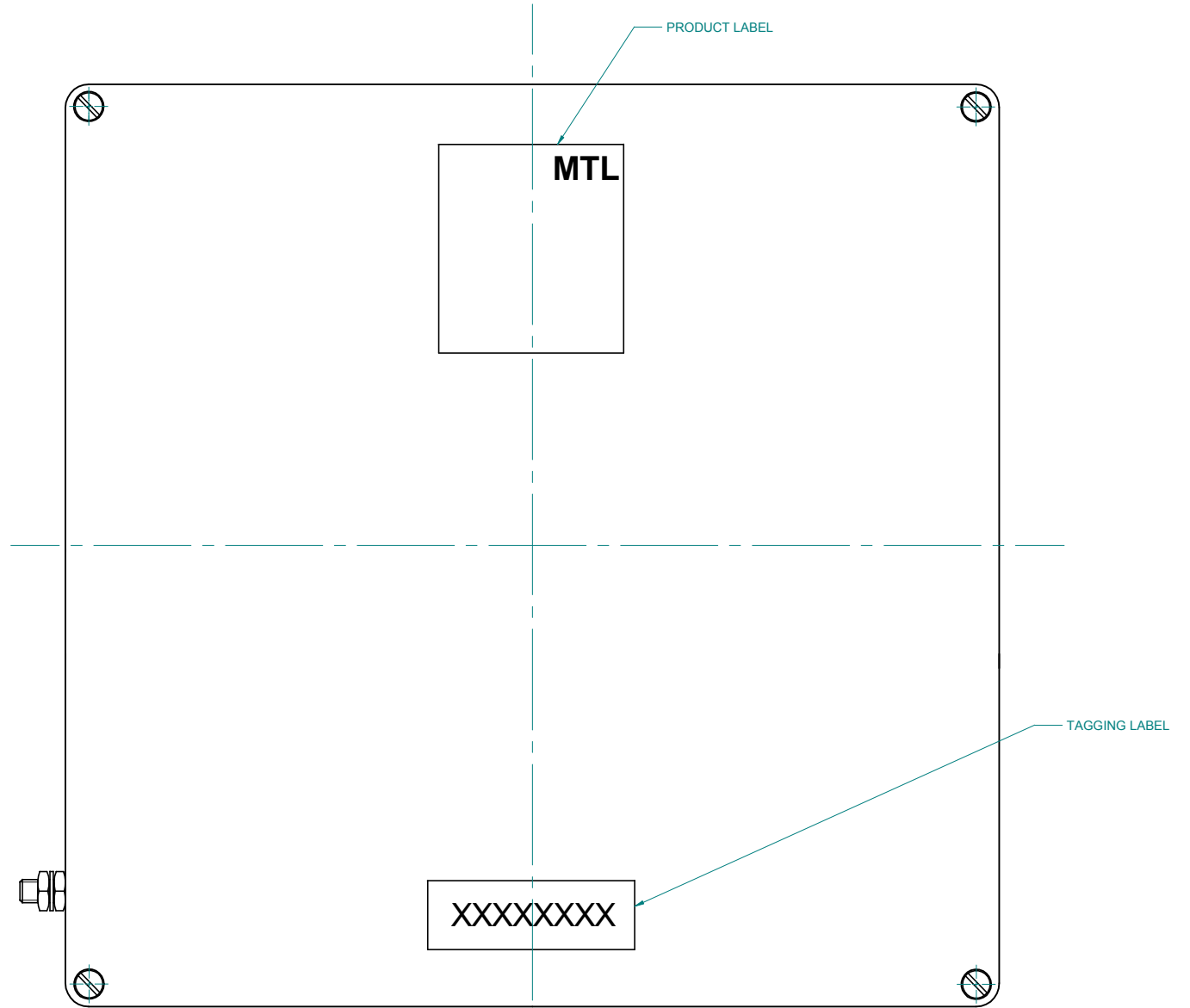

VIEW SHOWING POSITION OF CABLE GLAND AND BREATHER. GLAND NOT SHOWN FOR CLARITY

NOTES:

1. EEx e TYPE IP66 POLYESTER ENCLOSURE, WITH SCREW FIX LID
2. INTERNAL/ EXTERNAL M10 EARTH STUD FITTED.
3. 2 x DIN RAILS TO EN50022 35x7.5 "T" SECTION, MOUNTED VERTICALLY. EACH RAIL FITTED WITH 2 END STOPS.
4. 22 x M20 HOLES DRILLED EQUI-SPACED ON BOTTOM, IP66 EEx e CERTIFIED BREATHER PLUG FITTED IN POSITION SHOWN. 21 x M20 HOLES FOR 1 TRUNK IN FOR 2-PAIR CABLE & 20 SPUR CONNECTIONS OUT.
5. PART NUMBERS ENDING FCS-8520-XXX-01 TO FCS-8520-XXX-20 INDICATES QUANTITY OF SPUR GLANDS FITTED. ALL UNUSED GLAND POSITIONS ARE FITTED WITH BLANKING PLUGS THAT USE THE SAME MATERIAL AS THE GLANDS. SEE CD-FCS-1000 FOR BLANKING PLUG & GLANDING OPTIONS.
6. PRODUCT LABEL & TAGGING LABEL, [WHERE SPECIFIED], FITTED ON LID. ENCLOSURE PART No. LABEL FITTED INSIDE OF LID
7. JUNCTION BOX DESIGNED FOR MEGABLOCKS WITH 2 DIN RAILS, EACH FOR 1 x 10 WAY, OR 2, 4, 8 WAY MEGABLOCKS OR OTHER FIELD BUS WIRING COMPONENTS. SEE DATA SHEET APPLICATION EXAMPLES.

1	10.04	
Iss	Date	Modification

Scale	1:2
Tolerance	N/A

Copyright Reserved
Written Permission To Copy
Should Be Obtained

Measurement Technology Ltd
Power Court, Luton, England



Title	PROCESS JUNCTION BOX, POLYESTER, 20 SPUR
-------	------------------------------------------

Drg No	CD-FCS-8520
Iss.	1